



Henry Bird Way

Southbridge, Northampton

oriordanbond
SALES & LETTINGS



GROUND FLOOR
548 sq.ft. (50.9 sq.m.) approx.

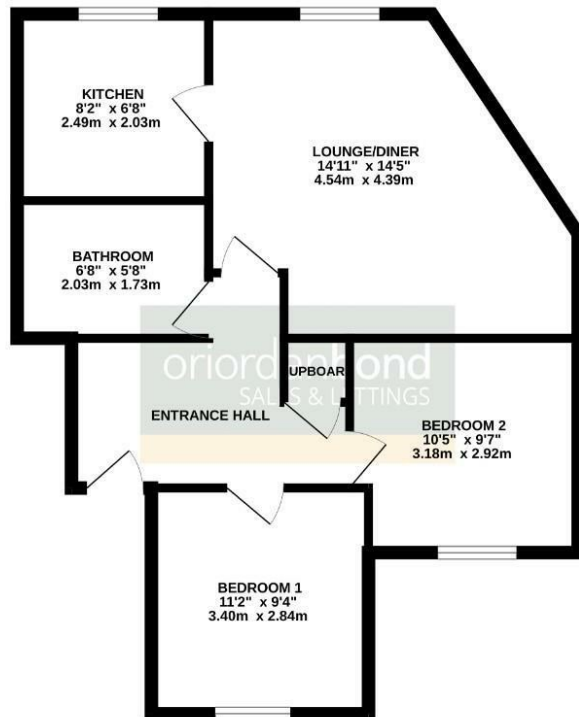

TOTAL FLOOR AREA: 548sq.ft. (50.9 sq.m.) approx.
Whilst every attempt has been made to ensure the accuracy of the floorplan contained here, measurements of doors, windows, rooms and any other items are approximate and no responsibility is taken for any error, omission or misstatement. This plan is for illustrative purposes only and should be used as such by any prospective purchaser. The services, systems and appliances shown have not been tested and no guarantee as to their operability or efficiency can be given.
Made with Metapic 6.0.0.5

Henry Bird Way

Southbridge

NN4 8GE

OFFERS OVER £115,000

This two double bedroom second floor apartment, offered for sale with no chain, is in the very popular area of Southbridge, part of NN4. Provides good access to Northampton town centre and train station.

The accommodation comprises communal entrance with stairs to all floors, entrance hall, sitting/dining room, fitted kitchen with appliances, two double bedrooms and a three-piece bathroom suite. Benefits include an allocated parking space, double glazing and electric storage heaters. (C/548/-)

Leasehold Information: Lease Remaining - 102 years (as of 2025) / Ground Rent - £295 per annum / Service Charge - £517 per quarter (£2068 per annum)

Additional information

- Council Tax Band: C
- Energy Efficiency Rating: C

Viewing

Viewing strictly by appointment – details below

Disclaimer

O'Riordan Bond Estate Agents Limited has not tested apparatus, equipment, fittings or services and so cannot verify they are in working order. The buyer is advised to obtain verification from their solicitor or surveyor.

O'Riordan Bond Far Cotton Sales

01604 706007

farcotton@oriordanbond.co.uk

